

East Pole Road

BakerRidge Signage

Private Gated Drive

BakerRidge

Another quality project by BakerLange Properties LLC

Windermere Real Estate/Whatcom, Inc.

Contact Jeff Baker

Mobile: 360-739-3236

Email: jeffbaker@windermere.com web: www.bakerridgelots.com

Protective tree line.

Community Park

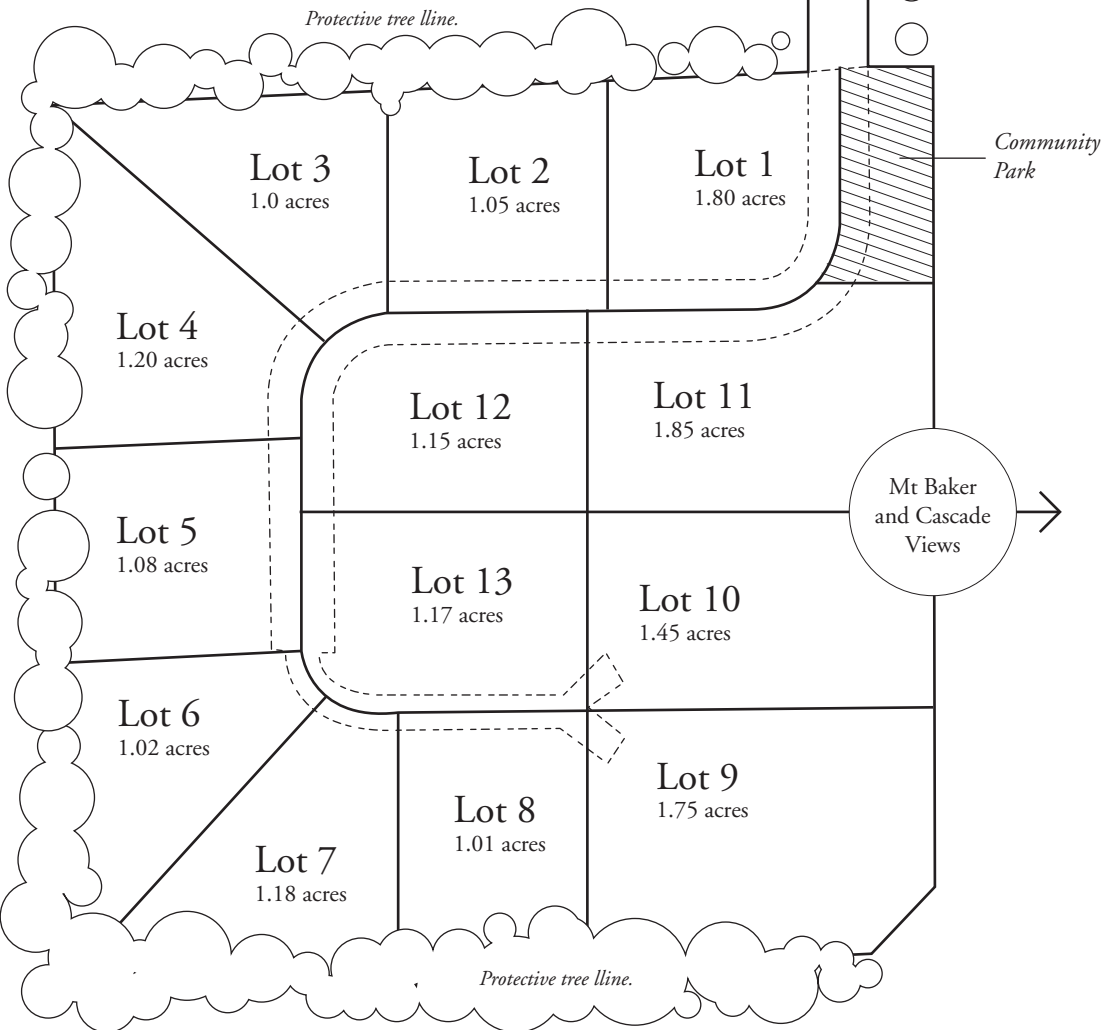

Welcome to BakerRidge, a private, gated community. This brand new subdivision is located between Bellingham and Lynden, WA. It is close to the Canadian border and is convenient to Interstate-5. The sandy beaches and salt waters of Birch Bay are only minutes away and an hour drive will take you to the majestic Cascade Mountain Range. BakerRidge consists of 13 1+ acre building sites. It is uniquely situated on the fringes of huge open spaces, green pastures, and beautiful agricultural land. The views to the east of BakerRidge are spectacular to say the least! These include the Cascade Mountain Range, Mt. Baker and the Twin Sisters. You won't believe the kaleidoscope of sunsets, sunrises, moonrises, and their effects on the ever-changing snow levels and gorgeous cloud formations. These open, light and bright lots are protected and surrounded on the remaining perimeter by bordering tree lines. BakerRidge amenities and features include a private entrance gate with landscaping and custom identifying sign, paved drive with street lamps, security mailboxes, private park, perimeter fencing, protective covenants, homeowners association, excellent sandy loam soils for beautiful lawns and gardens, and hassle-free building sites with all services available. This project is designed to be upscale and classy in every way...it is truly a piece of rare earth! All you will need are a set of plans to get started...Your dream is that close!